

# SV10 Light

120VAC/250W  
240VAC/250W



## **Introduction:**

Congratulations on the purchase of your new thru hull light (**Patent Pending**). Underwater Lights® USA, LLC takes pride in providing well designed, high quality and thoroughly tested lights that allow you to “enhance your boating experience”. These lights can be installed in your vessel for aesthetics, to attract fish, for security and safety.

## **General Operating Information:**

The 250W, HID, gas discharge lamp used in this light is not an instant re-strike lamp. This means that it must be allowed to cool for approximately 10 to 20 minutes after being shut off before being restarted. HID lamps generally require approximately 2 minutes to reach full brightness and should be left on for a minimum of 10 minutes. Failure to do so may cause the lamp to flicker when it is turned on the next time.

The light can be operated for a brief period of time when the vessel is out of the water, but, it is crucial that the vessel is in the water to ensure proper lamp cooling, however, the light can be operated while the vessel is underway.

Depending upon water clarity conditions, the light beam can reach up to 30 meters (100 feet).

## **General Safety Information:**

This light is intended for use on fiberglass and wood hulled vessels.

Never try to install or remove this light while the vessel is in the water.

High temperature silicone electrical cable must be used between the light and the ballast, standard ships cable can be used from the A/C power source to the ballast.

The body of the light must be electrically joined to the vessels grounding and cathodic protection system. Failure to do so may cause corrosion.

Always disconnect and lock-out power before working on light.

The light should be visually inspected every six months.

The light electrical cabling and ballast box should be visually inspected for proper operating condition every six months.

Marine growth should be removed from the glass using a soft brush to allow both heat and illumination to exit the light.

## **Technical Specifications:**

Lamp = 250 Watt - Metal halide - 17,000 Lumens - 8000 Kelvin color temperature - Approximately 3,000 hours life

Glass = Borosilicate Glass - 12.7mm (0.5”) thick - 58mm (2.3”) diameter net aperture

Dimensions = 130mm (5.12”) diameter x 203mm (8.0”) long - 3.5 kilograms (8 pounds)

Construction = Marine bronze - Black anodized marine aluminum alloy

Power supply = 120VAC 50/60Hz input, 2.38 Amps - Minimum operating temperature -30°C (-22°F)

OR

Power supply = 240VAC 50/60Hz input, 1.15 Amps - Minimum operating temperature -30°C (-22°F)

## **Troubleshooting:**

Please contact our technical support staff in Florida at 1-954-760-4447, Monday to Friday from 8:00 am to 5:00 pm EST.

## **Warranty:**

Underwater Lights® USA, LLC warrants this light to be free from defects in workmanship and materials for a period of two years from the date of original purchase (except lamps). Further, misuse, abuse, improper installation, neglect, improper shipping, damage caused by disasters such as fire, flood and lightning, unauthorized repair or modifications will void said warranty. Should your light prove defective during the warranty period, promptly contact Underwater Lights® USA, LLC for an RMA number and then return the light freight prepaid with the RMA number clearly marked on the outside of the shipping container.

Underwater Lights USA, LLC  
277 SW 33rd Court  
Fort Lauderdale, FL 33315 USA  
Phone: 1-954-760-4447  
Fax: 1-954-525-3261  
Internet: [www.seavision.com](http://www.seavision.com)  
Email: [sales@seavision.com](mailto:sales@seavision.com)



DOC:071007-2W

Underwater Lights Europe Sarl  
Résidence L'Hippocampe: 19, Avenue Thiers  
06600 Antibes, France  
Phone: 33-(0)-4-97-21-02-96  
Fax: 33-(0)-4-97-21-10-96  
Internet: [www.seavision.com](http://www.seavision.com)  
Email: [sales@seavisioneurope.com](mailto:sales@seavisioneurope.com)

# SV10 Light

120VAC/250W  
240VAC/250W



## Installation:

This light should be installed at least 250-300mm (10-12") below the water line by qualified/approved personnel using proper tools and materials. The minimum hull thickness is 10mm (0.4") and maximum is 90mm (3.5") with an access area of at least 75mm (3") left behind the light for lamp servicing and general ventilation.

After selecting a flat surface, cut a 100mm (4") diameter hole through the vessel hull in the desired location. Caution! Check that no electrical wiring, fuel lines, oil lines, water lines etc., pass near or through the intended hole location.

For light disassembly remove six nuts (24), remove (9), carefully disconnect ground wire, then remove (8), (7) + (6) from (1). **Warning! Do not rotate (8) while attached to (9) or ground wire damage will occur!** Carefully coat (1), (2) and inner surface of hull hole with 3M 5200 Marine Adhesive or equivalent. Caution! Avoid placing excess adhesive on (1) threads. Note: Exposed inner hole surface must be properly sealed before light installation to prevent potential water intrusion into the hull proper. Holding (2), push (1) through hull hole, slide (6) over (1) and then tighten (7) hand tight. Note: Ensure that the tips of all six fasteners (21) are NOT touching (6). After the 3M 5200 Marine Adhesive is fully cured, tighten six fasteners (21) to 9 Nm (7 ft/lbs) using a 5mm allen wrench.

Upon making proper electrical connections (see ballast manual), reverse aforementioned light disassembly procedure and tighten six nuts (24) in a criss-cross pattern to 2 Nm (1.5 ft/lbs). Note: Apply anti-seize compound to (8) internal threads. Also, it is highly recommended that (2) be coated with antifouling paint and a wire lead be connected from (7) tapped hole (M4 x 0.7 thread) to the vessels grounding and cathodic protection system.

## Serviceable Parts:

For Lamp replacement remove nuts (24), remove (9), carefully pull (17) out of (16), push new (17) into (16), install (9) and tighten nuts (24) in a criss-cross pattern to 2 Nm (1.5 ft/lbs). Caution! Ensure new lamp is clean of all contaminants and finger prints.

For glass replacement remove (24) + (9), disconnect ground wire, remove (8), (4) + (3), remove fasteners (20) and remove (11). Upon thoroughly cleaning all surfaces, reverse said procedure to assemble and tighten nuts (24) in a criss-cross pattern to 2 Nm (1.5 ft/lbs). Note: Fasteners (20) are tightened in a criss-cross pattern to 9 Nm (7 ft/lbs) using a 5mm allen wrench.

BALLOON	DESCRIPTION
1	MAIN BODY
2	FRONT FLANGE
3	GLASS RETAINING RING
4	REFLECTOR TUBE
5	REFLECTOR
6	COMPRESSION RING
7	LOCKING RING
8	CONNECTING RING
9	PROJECTOR LID
10	GLASS
11	GLASS GASKET
12	CONNECTING RING GASKET
13	REFLECTOR TUBE O-RING
14	PROJECTOR LID O-RING
15	FRONT FLANGE O-RING
16	LAMP SOCKET
17	LAMP, 250 WATT
18	PORCELAIN TERMINAL BLOCK
19	CABLE STRAIN RELIEF
20	M6 x 1.0 x 14LG SST SHCS
21	M6 x 1.0 x 14LG SST SHCS
22	M3 x 0.5 x 20LG SST SHCS
23	M6 x 1.0 x 25LG SST SET SCREW
24	M6 X 1.0 SST HEX LOCKNUT
25	STAND-OFF
26	M4 x 0.7 x 35LG SST SHCS
27	LAMP SOCKET SPACER

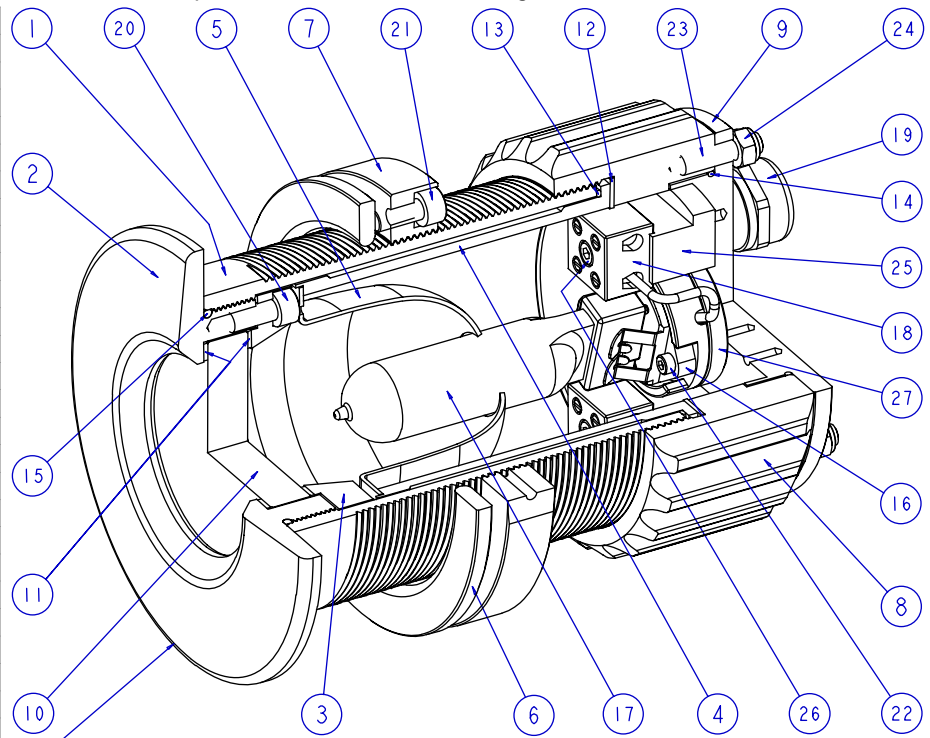

130mm (5.12") OD x 203mm (8.0") OAL. NOTE: REQUIRES A 100mm (4.0") DIAMETER HOLE

Underwater Lights USA, LLC  
277 SW 33rd Court  
Fort Lauderdale, FL 33315 USA  
Phone: 1-954-760-4447  
Fax: 1-954-525-3261  
Internet: [www.seavision.com](http://www.seavision.com)  
Email: [sales@seavision.com](mailto:sales@seavision.com)



DOC:071007-2W

Underwater Lights Europe Sarl  
Résidence L'Hippocampe: 19, Avenue Thiers  
06600 Antibes, France  
Phone: 33-(0)-4-97-21-02-96  
Fax: 33-(0)-4-97-21-10-96  
Internet: [www.seavision.com](http://www.seavision.com)  
Email: [sales@seavisioneurope.com](mailto:sales@seavisioneurope.com)