

DV12 Light, 12VDC or 24 VDC



Introduction:

Congratulations on the purchase of your new deck light. Underwater Lights® USA, LLC takes pride in providing well designed, high quality and thoroughly tested lights that allow you to “enhance your boating experience”. These lights can be installed in your vessel for aesthetics, security and safety.

General Operating Information:

The commercial grade Halogen lamp used in this light will provide robust and reliable operation under normal operating conditions.

General Safety Information:

This light is intended for vessel interior or exterior (rain or indirect water spray) lighting applications.

Always disconnect and lock-out power before working on light.

Technical Specifications:

Lamp = 10 Watt - Halogen - 3000 Kelvin color temperature - Approximately 2,000 hours life

Glass = Borosilicate glass - 3.2mm (0.125”) thick - 34mm (1.3”) diameter net aperture

Dimensions = 60mm (2.36”) diameter x 68.5mm (2.7”) long - 120 grams (4.2 ounces) - Fits through a 36mm (1.4”) diameter hole

Construction = Stainless steel - White PTFE (Teflon)

Power supply = 12VDC / AC - 0.8 Amps, 24VDC - 0.3 Amps - Minimum operating temperature -30°C (-22°F)

Troubleshooting:

Please contact our technical support staff in Florida at 1-954-760-4447, Monday to Friday from 8:00 am to 5:00 pm EST.

Warranty:

Underwater Lights® USA, LLC warrants this light to be free from defects in workmanship and materials for a period of one year from the date of original purchase (except lamps). Further, misuse, abuse, improper installation, neglect, improper shipping, damage caused by disasters such as fire, flood and lightning, unauthorized repair or modifications will void said warranty. Should your light prove defective during the warranty period, promptly contact Underwater Lights® USA, LLC for an RMA number and then return the light freight prepaid with the RMA number clearly marked on the outside of the shipping container.

DV12 Light, 12VDC or 24 VDC



Installation:

After selecting a flat surface, cut a 36mm (1.4") diameter hole through said surface at the desired location. Caution! Check that no electrical wiring, fuel lines, oil lines, water lines etc., pass near or through the intended hole location.

Unscrew Front Flange (2) and remove three supplied Phillips Pan Head Screws (10). Place Main Body (1) with Body Gasket (4) through above hole and secure using three Phillips Pan Head Screws (10). Note: Depending upon installation surface material, three small pilot holes may be required. Screw the Front Flange (2) onto the Main Body (1) hand tight.

Connect the first wire lead to a switched and fused power source then connect the second wire lead to good ground. Note: The light has no electrical polarity.

Serviceable Parts:

Lamp replacement is done by unscrewing the Front Flange (2), pulling the old Lamp (8) out of the Lamp Socket (7), pushing a new Lamp (8) into the Lamp Socket (7), then screwing the Front Flange (2) onto the Main Body (1) hand tight. Caution! Ensure that the new lamp is clean and free of dust, dirt, grease, oil, water and finger prints. Additionally, the Glass (3) is not field serviceable on this light because it is permanently bonded to the Front Flange (2).

BALLOON	DESCRIPTION
1	MAIN BODY
2	FRONT FLANGE, STAINLESS STEEL, MIRROR FINISH*
3	GLASS, FROSTED*
4	BODY GASKET
5	CABLE STRAIN RELIEF
6	REFLECTOR
7	LAMP SOCKET
8	LAMP, 10 WATT, 12VDC*
9	FRONT FLANGE O-RING
10	No. 4 x 5/8" LG STAINLESS STEEL PHILLIPS PAN HEAD SCREW

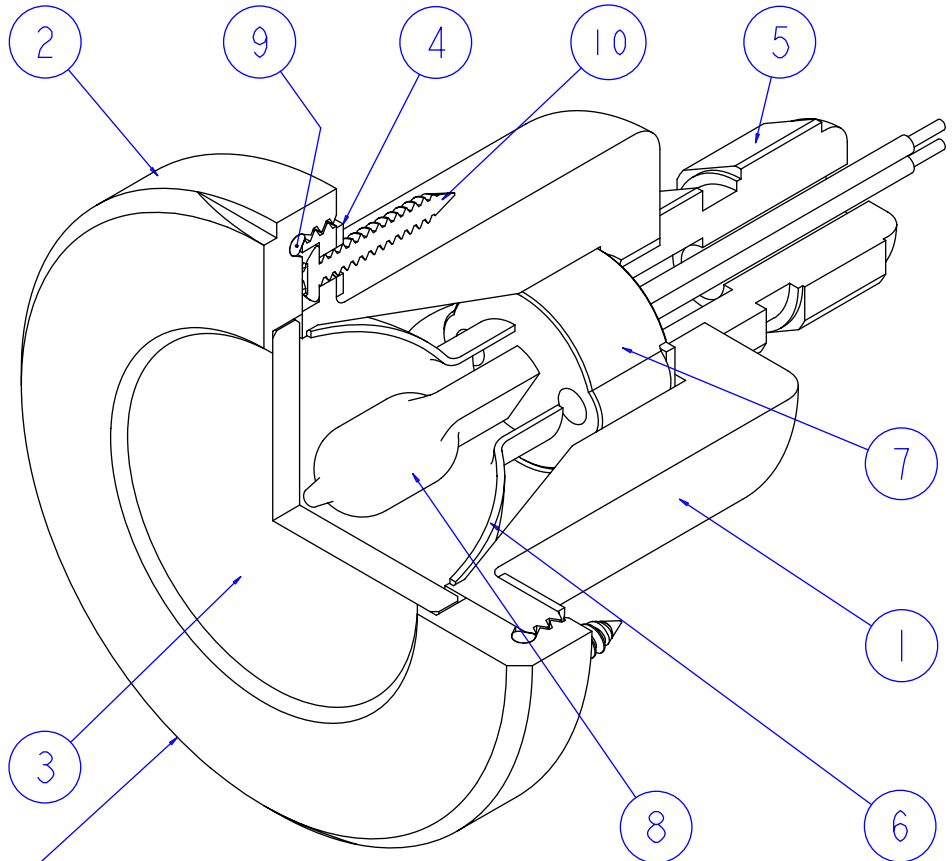

60mm (2.4") OD x 68.5mm (2.7") OAL. NOTE: REQUIRES A 36mm (1.4") DIAMETER HOLE

Underwater Lights USA, LLC
 277 SW 33rd Court
 Fort Lauderdale, FL 33315 USA
 Phone: 1-954-760-4447
 Fax: 1-954-525-3261
 Internet: www.seavision.com
 Email: sales@seavision.com

DOC:021805-9W

Underwater Lights Europe Sarl
 Résidence L'Hippocampe: 19, Avenue Thiers
 06600 Antibes, France
 Phone: 33-(0)-4-97-21-02-96
 Fax: 33-(0)-4-97-21-10-96
 Internet: www.seavision.com
 Email: sales@seavisioneurope.com