

SV42-Thru Hull



This light has an LED array in a bronze housing designed for boats 40' and under that want LED lighting. This light is excellent for any boat which has limited interior access but desires a thru hull installation avoiding any exterior wiring.



SV42 technical specifications

Application for:	GRP / fiberglass / wood hulls
Lamp:	Six LED modules Available in white or blue
Life length:	approx. 30,000 hours
Kelvin color temp:	6500
Glass lens:	Convex crown glass
Thickness:	0.93" / 23.5mm x 2.2" / 57mm
Power supply:	11-28 VDC - 1.47 amps
Casing material:	Marine Bronze
Dimensions:	7.36" / 187mm x 3.15" / 80mm

Weight:	1.4 kg / 3 lbs
Code:	SV42 – Thru hull
Total shipping weight:	1.8 kg / 4 lbs
Installation:	recommended at least 5-6" (125-150mm) below waterline between 3-6 feet (1-2 meters) apart. The placement of surface mounted underwater lights on the hull bottom or sides is not recommended

All information is subject to change without prior notice, please confirm details prior to ordering.

SV42 Light

THRU HULL, LED ARRAY,
12VDC or 24VDC



Introduction:

Congratulations on the purchase of your new thru hull LED light (Patent Pending). Underwater Lights® USA, LLC takes pride in providing well designed, high quality and thoroughly tested lights that allow you to “enhance your boating experience”. These lights can be installed in your vessel for aesthetics, to attract fish, for security and safety.

General Operating Information:

The commercial grade Light Emitting Diode (LED) technology used in this light will provide robust and reliable operation under normal operating conditions.

Depending upon water clarity conditions, the light beam can reach up to 9 meters (30 feet).

General Safety Information:

This light is intended for use on fiberglass and wood hulled vessels.

Never try to install or remove this light while the vessel is in the water.

The body of the light must be electrically joined to the vessels grounding and cathodic protection system. Failure to do so may cause corrosion.

Always disconnect and lock-out power before working on light.

The light and electrical cabling thereof should be visually inspected for proper operating condition every six months.

Marine growth should be removed from the convex glass using a soft brush to allow illumination to exit the light.

Technical Specifications:

Light source = White LED array - 6500 Kelvin color temperature and 1067 lumens or alternate Blue LED array - Approximately 30,000 hours life for each color - Internal thermal limit protection included

Light glass = Convex crown glass - 23.5mm (0.93”) thick - 57mm (2.2”) diameter net aperture

Light dimensions = 80mm (3.15”) diameter x 187mm (7.36”) long - 1176 grams (2.6 lbs)

Light construction = Marine bronze

Power source = 11-28VDC input range - 1.47 Amps maximum - Operating temperature from -30°C (-22°F) to 50°C (122°F)

Troubleshooting:

Please contact our technical support staff in Florida at 1-954-760-4447, Monday to Friday from 8:00 am to 5:00 pm EST.

Warranty:

Underwater Lights® USA, LLC warrants this light to be free from defects in workmanship and materials for a period of two years from the date of original purchase. Further, misuse, abuse, improper installation, neglect, improper shipping, damage caused by disasters such as fire, flood and lightning, unauthorized repair or modifications will void said warranty. Should your light prove defective during the warranty period, promptly contact Underwater Lights® USA, LLC for an RMA number and then return the light freight prepaid with the RMA number clearly marked on the outside of the shipping container.

Underwater Lights USA, LLC
277 SW 33rd Court
Fort Lauderdale, FL 33315 USA
Phone: 1-954-760-4447
Fax: 1-954-525-3261
Internet: www.seavision.com
Email: sales@seavision.com

DOC:072707-1

Underwater Lights Europe Sarl
Résidence L'Hippocampe: 19, Avenue Thiers
06600 Antibes, France
Phone: 33-(0)-4-97-21-02-96
Fax: 33-(0)-4-97-21-10-96
Internet: www.seavision.com
Email: sales@seavisioneurope.com

SV42 Light

THRU HULL, LED ARRAY,
12VDC or 24VDC



Installation:

This light should be installed at least 125-150mm (5-6") below the water line by qualified/approved personnel using proper tools and materials. The minimum hull thickness is 10mm (0.4") and maximum is 102mm (4"). After selecting a flat surface, cut a 19mm (0.75") diameter hole through the vessel hull in the desired location. Caution! Check that no electrical wiring, fuel lines, oil lines, water lines etc., pass near or through the intended hole location. The placement of surface mounted underwater lights on the hull bottom or sides is not recommended.

Remove Locking Ring (9) and Compression Ring (8) from Main Body (2). Carefully coat Main Body (2) and inner surface of hull hole with 3M 4200 Marine Adhesive or equivalent. Caution! Avoid placing excess adhesive on Main Body (2) threads. Note: Exposed inner hole surface must be properly sealed before light installation to prevent potential water intrusion into the hull coring. Holding Front Flange (1), push Electrical Cable (11) and Main Body (2) through hull hole, slide Compression Ring (8) over Main Body (2), and then install Locking Ring (9) hand tight. Note: Ensure that the tips of all three Set Screws (10) are NOT touching Compression Ring (8). After the 3M 5200 Marine Adhesive is fully cured, evenly tighten three Set Screws (10) to 7 Nm (5 ft/lbs) using a 3mm allen wrench. Also, it is highly recommended that Front Flange (1) be coated with antifouling paint and a wire lead be connected from Locking Ring (9) tapped hole (M4 x 0.7 thread) to the vessels grounding and cathodic protection system.

Connect RED wire lead to a switched and fused power source and connect BLACK wire lead to a good ground. Caution! Avoid making tight bends and/or passing Electrical Cable (11) over sharp edges/surfaces.

Serviceable Parts:

LED Array (6) and Electrical Cable (11) are not field serviceable on this light but Strain Relief O-ring (12) and Cable Strain Relief (13) can be replaced as needed. Convex Glass (3), Glass O-ring (4), Glass Gasket (14) and Main Body O-ring (5) can be replaced by removing five Socket Flat Head Screws (7) and carefully separating Front Flange (1) from Main Body (2). Note: Evenly hand tighten the five Socket Flat Head Screws (7) after carefully re-assembling said parts.

MODELS G12A11B39 WHITE & G12A11B40 BLUE, 12/24VDC		
BALLOON	PART	DESCRIPTION
1	42018	FRONT FLANGE, BRONZE*
2	42084	MAIN BODY, BRONZE*
3	42011	CONVEX GLASS
4	42012	GLASS O-RING
5	42013	MAIN BODY O-RING
6	42089 42090	WHITE LED ARRAY BLUE LED ARRAY
7	42015	M3 x 0.5 x 12 LG SST SOCKET FHS
8	42028	COMPRESSION RING, BRONZE*
9	42033	LOCKING RING, BRONZE*
10	42038	M6 x 1.0 x 16LG SST SOCKET SET SCREW
11	42017	ELECTRICAL CABLE
12	42039	STRAIN RELIEF O-RING
13	42040	CABLE STRAIN RELIEF
14	42052	GLASS GASKET
15	42063	M2 x 0.4 x 5 LG SST PHILLIPS PHS
*PLEASE CALL FOR OTHER LIGHT COMPONENT CONFIGURATIONS		

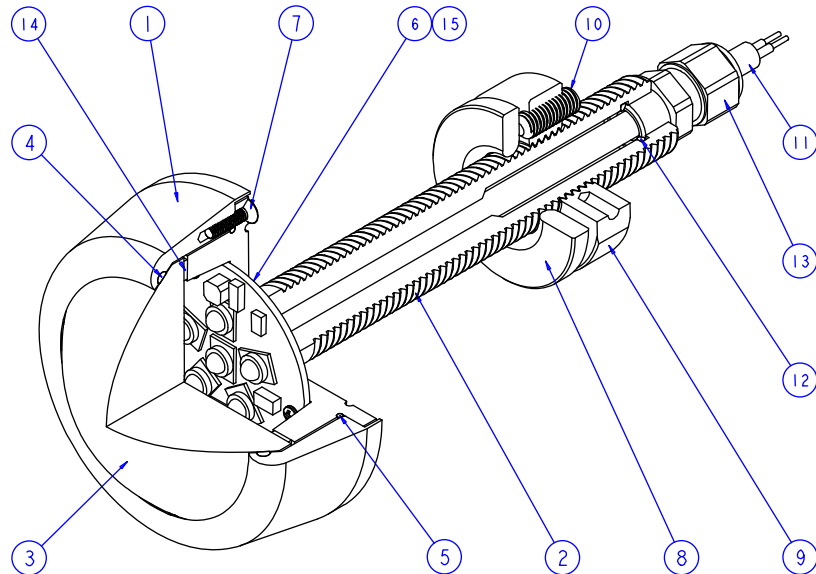

Underwater Lights USA, LLC
277 SW 33rd Court
Fort Lauderdale, FL 33315 USA
Phone: 1-954-760-4447
Fax: 1-954-525-3261
Internet: www.seavision.com
Email: sales@seavision.com

Underwater Lights Europe Sarl
Résidence L'Hippocampe: 19, Avenue Thiers
06600 Antibes, France
Phone: 33-(0)-4-97-21-02-96
Fax: 33-(0)-4-97-21-10-96
Internet: www.seavision.com
Email: sales@seavisioneurope.com

DOC:072707-1