

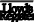

The Sea Vision SV37 weld in model for aluminum or steel hulls can be installed in the transom or the hull, it utilizes a 250 watt HID metal halide lamp and 110 or 230 volt AC power. The lights can be welded at adjustable angles to suit all hull shapes. The hull shape and positioning will dictate the angle of the light you require, angles available are 0 to 50 degree. The 98 mm / 3.8" aperture lens gives the largest volume of light available in a welded fixture. This light was specifically designed to include an intricate cofferdam that is welded to the thru hull providing a very easy way for the shipyard to satisfy the demands of the classification societies for secondary containment of the lights. This fixture is primarily for larger yachts.



## SV37 technical specifications

Application for:	Aluminum or Steel hulls	Angles available:	Flush 30 degree 24 – 38 degree 38 – 50 degree
Lamp:	250 watt HID metal halide	Ballast:	120 VAC 50/60Hz 230 VAC 50/60Hz
Life length:	approx. 3,000 hours plus	Cable:	Only required between the light and the ballast (maximum distance 15 feet / 4.5 meters). High temperature silicone 18/3 shielded copper wire. Normal ships cable can be used from the ballast to the power supply.
Lumens:	20,000	Also available with an intrical igniter eliminating the need for special cable between the ballast and the light.	
Kelvin color temp:	8000	Code:	SV37
Glass lens:	Borosilicate glass	Installation:	recommended at least 10" (250mm) below the waterline between 3-8 feet (1-2.5 meters) apart.
Thickness:	20mm / 0.79"	<i>This is a guideline only, for specific requirements please contact us.</i>	
Power supply:	120 VAC 50/60Hz, running current 2.38 Amps 230 VAC 50/60Hz, running current 1.15 Amps	<i>Note: Please specify voltage when ordering. All information is subject to change without prior notice, please confirm details prior to ordering.</i>	
Casing material:	Aluminum 5036 / Stainless Steel 316L	<b>CE  ABS</b>	
Dimensions:	flush – 175mm x 48mm / 6.9" x 1.9" 30 degree – 175mm x 120mm / 6.9" x 4.7" 24-38 degree – 226mm x 192mm / 8.9" x 7.5" 50 degree – 226mm x 359mm / 8.9" x 14.1"		

# SV37 Light

120VAC/250W  
240VAC/250W



## **Introduction:**

Congratulations on the purchase of your new weld-in light (**Patent Pending**) for **STEEL** hulled vessels. Underwater Lights™ USA, LLC takes pride in providing well designed, high quality and thoroughly tested lights that allow you to “enhance your boating experience”. These lights can be installed in your vessel for aesthetics, to attract fish, for security and safety.

## **General Operating Information:**

The 250W, HID, gas discharge lamp used in this light is not an instant re-strike lamp. This means that it must be allowed to cool for approximately 10 to 20 minutes after being shut off before being restarted. HID lamps generally require approximately 2 minutes to reach full brightness and should be left on for a minimum of 10 minutes. Failure to do so may cause the lamp to flicker when it is turned on the next time.

The light can be operated for a brief period of time when the vessel is out of the water, but, it is crucial that the vessel is in the water to ensure proper lamp cooling, however, the light can be operated while the vessel is underway.

Depending upon water clarity conditions, the light beam can reach up to 30 meters (100 feet).

## **General Safety Information:**

This light must be welded into a STEEL hulled vessel in accordance with common ship building practices.

Never try to install or remove this light while the vessel is in the water.

High temperature silicone electrical cable must be used between the light and the ballast, standard ships cable can be used from the A/C power source to the ballast.

Upon proper installation, this light will become part of the vessels grounding and cathodic protection system.

Always disconnect and lock-out power before working on light.

The light should be inspected for moisture every six months.

The light electrical cabling and ballast box should be visually inspected for proper operating condition every six months.

Marine growth should be removed from the glass using a soft brush to allow both heat and illumination to exit the light.

## **Technical Specifications:**

Lamp = 250 Watt - Metal halide - 20,000 Lumens - 8000 Kelvin color temperature - Approximately 3,000 hours life

Glass = Borosilicate glass - 20mm (0.79”) thick - 86mm (3.39”) diameter net aperture

Light Common Body Dimensions = 110mm (4.33”) diameter x 188mm (7.4”) long

Smallest Front Flange Dimensions = 175mm (6.89”) diameter x 49mm (1.9”) long

Largest Front Flange Dimensions = 226mm (8.89”) diameter x 359mm (14.1”) long

Construction = Stainless steel - Black anodized marine aluminum alloy

Power supply = 120VAC 50/60Hz input, 2.38 Amps - Minimum operating temperature -30°C (-22°F)

OR

Power supply = 240VAC 50/60Hz input, 1.15 Amps - Minimum operating temperature -30°C (-22°F)

## **Troubleshooting:**

Please contact our technical support staff in Florida at 1-954-760-4447, Monday to Friday from 8:00 am to 5:00 pm EST.

## **Warranty:**

Underwater Lights™ USA, LLC warrants this light to be free from defects in workmanship and materials for a period of two years from the date of original purchase (except lamps). Further, misuse, abuse, improper installation, neglect, improper shipping, damage caused by disasters such as fire, flood and lightning, unauthorized repair or modifications will void said warranty. Should your light prove defective during the warranty period, promptly contact Underwater Lights USA, LLC for an RMA number and then return the light freight prepaid with the RMA number clearly marked on the outside of the shipping container.

Underwater Lights USA, LLC  
1881 W State Road 84, Bay 102  
Fort Lauderdale, FL 33315 USA  
Phone: 1-954-760-4447  
Fax: 1-954-525-3261  
Internet: [www.seavision.com](http://www.seavision.com)  
Email: [sales@seavision.com](mailto:sales@seavision.com)

DOC:121606-4

Underwater Lights Europe Sarl  
Résidence L'Hippocampe: 19, Avenue Thiers  
06600 Antibes, France  
Phone: 33-(0)-4-97-21-02-96  
Fax: 33-(0)-4-97-21-10-96  
Internet: [www.seavision.com](http://www.seavision.com)  
Email: [sales@seavisioneurope.com](mailto:sales@seavisioneurope.com)

# SV37 Light

120VAC/250W  
240VAC/250W



## Installation:

This light should be installed at minimum 250-300mm (10-12") below the light load water line by qualified/approved personnel using proper tools, welding procedures and materials. An access area of at least 75mm (3") should be left behind the light for lamp servicing and general ventilation.

After selecting a location, cut an appropriate sized hole through the vessel hull. Note: Hole size will be defined by the specific weld-in Front Flange (22) that came with the light. Caution! Check that no electrical wiring, fuel lines, oil lines, water lines etc., pass near or through the intended hole location.

Place the supplied Front Flange (22) into said hole and following common ship building practices, permanently weld-in place. Note: Leave the factory installed block-off disk on the supplied Front Flange (22) until final light assembly.

Final light assembly - Remove Front Flange (22) block-off disk and clean all surfaces. Install two Glass Gaskets (7) [one gasket on either side of glass], Glass (6), Retaining Flange O-ring (9) and Glass Retaining Flange (2) using eight fasteners (15) tightened in a criss-cross pattern to 9 Nm (7 ft/lbs) using a 5mm allen wrench. Install Reflector (3), Main Body Gasket (8) and Main Body (1) into Glass Retaining Flange (2), then tighten Main Body (1) to 40 Nm (30 ft/lbs). Note: Apply anti-seize compound to Main Body (1) threads. After making proper electrical connections (see ballast manual), attach Projector Lid (5) to Main Body (1) using six Nuts (19) evenly tightened to 2 Nm (1.5 ft/lbs). Note: Upon completing light installation, it is highly recommended that Front Flange (22) be coated with antifouling paint.

## Serviceable Parts:

Lamp replacement is done by removing six Nuts (19) and Projector Lid (5), pulling old Lamp (12) out of Lamp Socket (11), carefully pushing new Lamp (12) into Lamp Socket (11) and then reversing said procedure. Note: Evenly tighten six Nuts (19) to 2 Nm (1.5 ft/lbs). Caution! Ensure that new lamp is clean and free of dust, dirt, grease, oil, water and finger prints.

Glass (6) replacement is done by removing eight fasteners (15), Glass Retaining Flange (2) with attached Main Body (1) and Glass Gaskets (7) while the boat is out of the water. Upon thoroughly cleaning all surfaces, reverse said procedure to assemble new Glass (6) and Glass Gaskets (7). Note: Tighten fasteners (15) in a criss-cross pattern to 9 Nm (7 ft/lbs) using a 5mm allen wrench.

MODEL E14_12A12-16A18A, 120VAC OR 240VAC, 250W		
BALLOON	PART	DESCRIPTION
1	37001	MAIN BODY
2	37002	GLASS RETAINING FLANGE
3	37004	REFLECTOR
4	37028	REFLECTOR BUSHING
5	37006	PROJECTOR LID
6	37007	GLASS
7	37008	GLASS GASKET
8	37009	MAIN BODY GASKET
9	37010	RETAINING FLANGE O-RING
10	37011	PROJECTOR LID O-RING
11	37030	LAMP SOCKET
12	37031	LAMP, 250 WATT
13	37015	PORCELAIN TERMINAL BLOCK
14	37016	CABLE STRAIN RELIEF
15	37017	M6 x 1.0 x 25LG SST SHCS
16	37036	M3 x 0.5 x 20LG SST SHCS
17	37035	M4 x 0.7 x 35LG SST SHCS
18	37019	M6 x 1.0 x 25LG SST SET SCREW
19	37020	M6 x 1.0 SST HEX LOCKNUT
20	37033	STAND-OFF
21	37034	LAMP SOCKET SPACER
22	N/A	CALL TECHNICAL SUPPORT FOR APPROPRIATE FRONT FLANGE

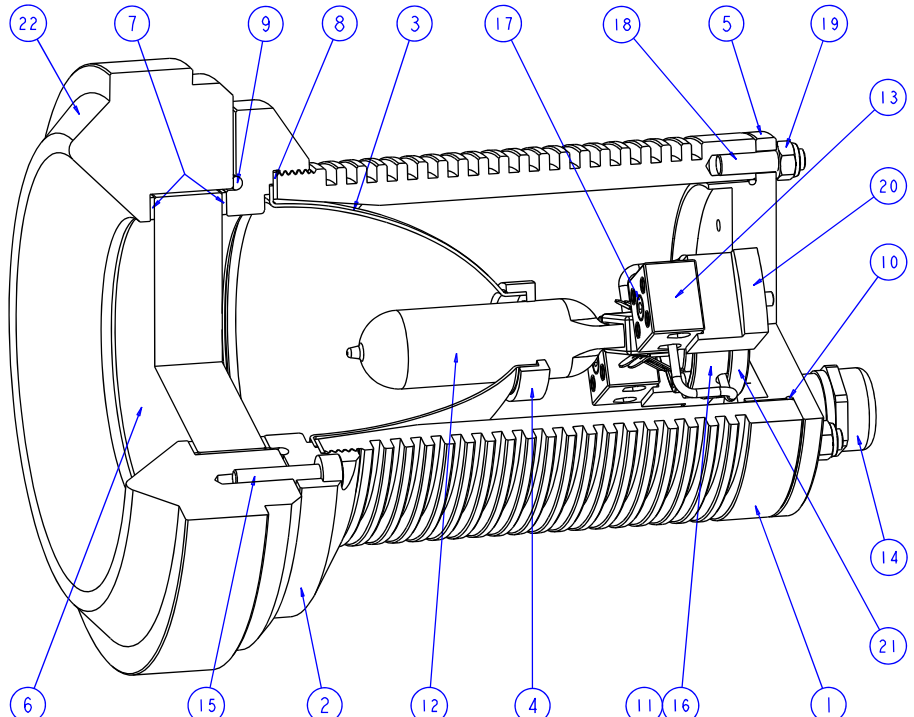

Underwater Lights USA, LLC  
1881 W State Road 84, Bay 102  
Fort Lauderdale, FL 33315 USA  
Phone: 1-954-760-4447  
Fax: 1-954-525-3261  
Internet: [www.seavision.com](http://www.seavision.com)  
Email: [sales@seavision.com](mailto:sales@seavision.com)

DOC:121606-4

Underwater Lights Europe Sarl  
Résidence L'Hippocampe: 19, Avenue Thiers  
06600 Antibes, France  
Phone: 33-(0)-4-97-21-02-96  
Fax: 33-(0)-4-97-21-10-96  
Internet: [www.seavision.com](http://www.seavision.com)  
Email: [sales@seavisioneurope.com](mailto:sales@seavisioneurope.com)

## Weld-in Front Flange Selection for **STEEL** Hulled Vessels

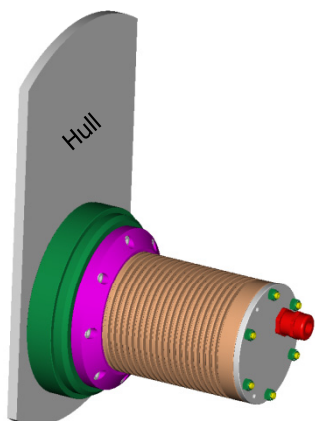

*Light with 0° to 10°  
SS Front Flange  
(37023)*

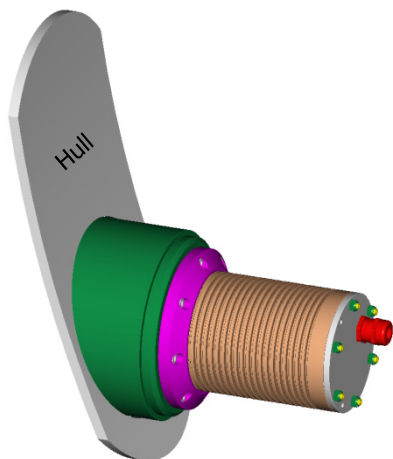
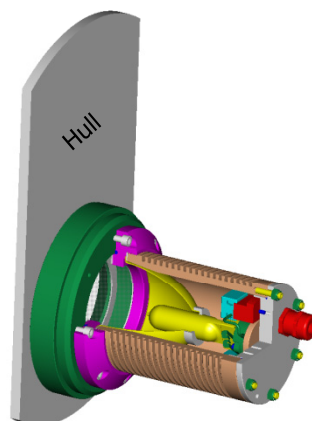

*Light with 10° to 30°  
SS Front Flange  
(37050)*

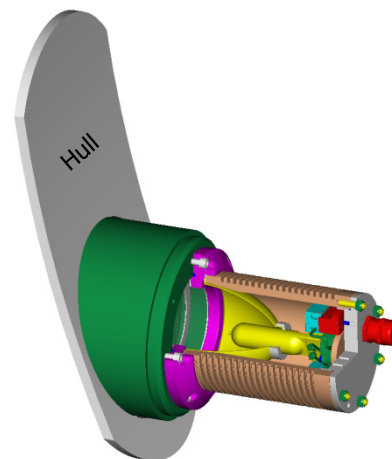

## Weld-in Front Flange Selection for **STEEL** Hulled Vessels

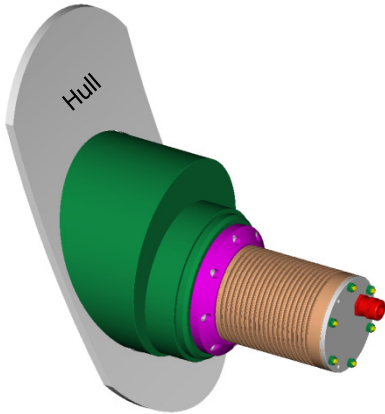

*Light with 24° to 38°  
SS Front Flange  
(37053)*

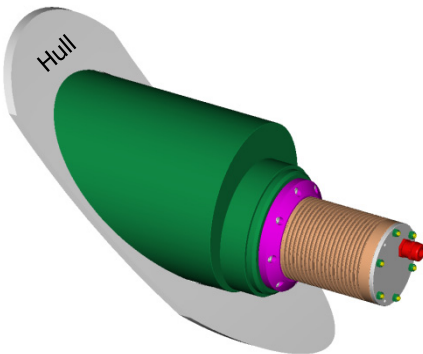
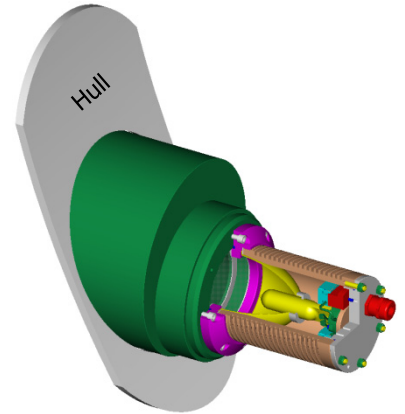

*Light with 38° to 50°  
SS Front Flange  
(37056)*

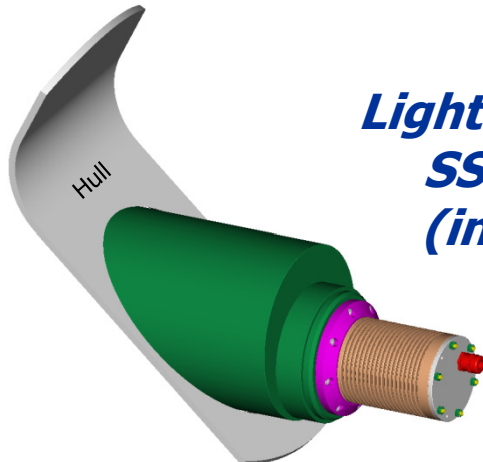
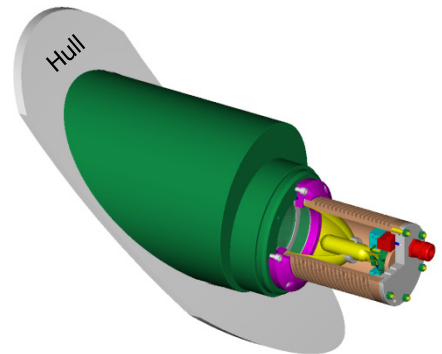

*Light with 38° to 50°  
SS Front Flange  
(in hull bottom)*

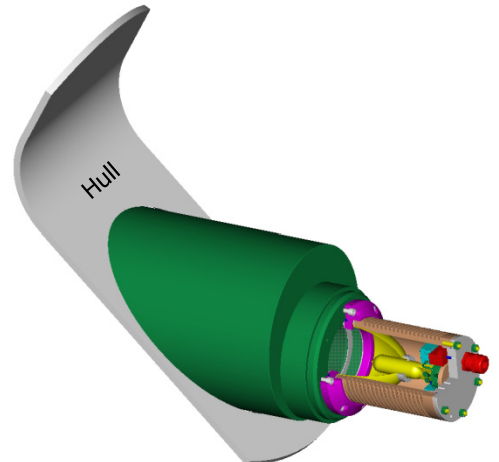

# SV37 Light

120VAC/250W  
240VAC/250W



## **Introduction:**

Congratulations on the purchase of your new weld-in light (**Patent Pending**) for **ALUMINUM** hulled vessels. Underwater Lights™ USA, LLC takes pride in providing well designed, high quality and thoroughly tested lights that allow you to “enhance your boating experience”. These lights can be installed in your vessel for aesthetics, to attract fish, for security and safety.

## **General Operating Information:**

The 250W, HID, gas discharge lamp used in this light is not an instant re-strike lamp. This means that it must be allowed to cool for approximately 10 to 20 minutes after being shut off before being restarted. HID lamps generally require approximately 2 minutes to reach full brightness and should be left on for a minimum of 10 minutes. Failure to do so may cause the lamp to flicker when it is turned on the next time.

The light can be operated for a brief period of time when the vessel is out of the water, but, it is crucial that the vessel is in the water to ensure proper lamp cooling, however, the light can be operated while the vessel is underway.

Depending upon water clarity conditions, the light beam can reach up to 30 meters (100 feet).

## **General Safety Information:**

This light must be welded into a ALUMINUM hulled vessel in accordance with common ship building practices.

Never try to install or remove this light while the vessel is in the water.

High temperature silicone electrical cable must be used between the light and the ballast, standard ships cable can be used from the A/C power source to the ballast.

Upon proper installation, this light will become part of the vessels grounding and cathodic protection system.

Always disconnect and lock-out power before working on light.

The light should be inspected for moisture every six months.

The light electrical cabling and ballast box should be visually inspected for proper operating condition every six months.

Marine growth should be removed from the glass using a soft brush to allow both heat and illumination to exit the light.

## **Technical Specifications:**

Lamp = 250 Watt - Metal halide - 20,000 Lumens - 8000 Kelvin color temperature - Approximately 3,000 hours life

Glass = Borosilicate glass - 20mm (0.79”) thick - 86mm (3.39”) diameter net aperture

Light Common Body Dimensions = 110mm (4.33”) diameter x 188mm (7.4”) long

Smallest Front Flange Dimensions = 175mm (6.89”) diameter x 120mm (4.7”) long

Largest Front Flange Dimensions = 226mm (8.89”) diameter x 359mm (14.1”) long

Construction = Bright dip anodized marine aluminum alloy - Black anodized marine aluminum alloy

Power supply = 120VAC 50/60Hz input, 2.38 Amps - Minimum operating temperature -30°C (-22°F)

OR

Power supply = 240VAC 50/60Hz input, 1.15 Amps - Minimum operating temperature -30°C (-22°F)

## **Troubleshooting:**

Please contact our technical support staff in Florida at 1-954-760-4447, Monday to Friday from 8:00 am to 5:00 pm EST.

## **Warranty:**

Underwater Lights™ USA, LLC warrants this light to be free from defects in workmanship and materials for a period of two years from the date of original purchase (except lamps). Further, misuse, abuse, improper installation, neglect, improper shipping, damage caused by disasters such as fire, flood and lightning, unauthorized repair or modifications will void said warranty. Should your light prove defective during the warranty period, promptly contact Underwater Lights USA, LLC for an RMA number and then return the light freight prepaid with the RMA number clearly marked on the outside of the shipping container.

---

Underwater Lights USA, LLC  
1881 W State Road 84, Bay 102  
Fort Lauderdale, FL 33315 USA  
Phone: 1-954-760-4447  
Fax: 1-954-525-3261  
Internet: [www.seavision.com](http://www.seavision.com)  
Email: [sales@seavision.com](mailto:sales@seavision.com)

DOC:121706-4

---

Underwater Lights Europe Sarl  
Résidence L'Hippocampe: 19, Avenue Thiers  
06600 Antibes, France  
Phone: 33-(0)-4-97-21-02-96  
Fax: 33-(0)-4-97-21-10-96  
Internet: [www.seavision.com](http://www.seavision.com)  
Email: [sales@seavisioneurope.com](mailto:sales@seavisioneurope.com)

# SV37 Light

120VAC/250W  
240VAC/250W



## Installation:

This light should be installed at minimum 250-300mm (10-12") below the light load water line by qualified/approved personnel using proper tools, welding procedures and materials. An access area of at least 75mm (3") should be left behind the light for lamp servicing and general ventilation.

After selecting a location, cut an appropriate sized hole through the vessel hull. Note: Hole size will be defined by the specific weld-in Front Flange (22) that came with the light. Caution! Check that no electrical wiring, fuel lines, oil lines, water lines etc., pass near or through the intended hole location.

Place the supplied Front Flange (22) into said hole and following common ship building practices, permanently weld-in place. Note: Leave the factory installed block-off disk on the supplied Front Flange (22) until final light assembly.

Final light assembly - Remove Front Flange (22) block-off disk and clean all surfaces. Install two Glass Gaskets (7) [one gasket on either side of glass], Glass (6), Retaining Flange O-ring (9) and Glass Retaining Flange (2) using eight fasteners (15) tightened in a criss-cross pattern to 9 Nm (7 ft/lbs) using a 5mm allen wrench. Install Reflector (3), Main Body Gasket (8) and Main Body (1) into Glass Retaining Flange (2), then tighten Main Body (1) to 40 Nm (30 ft/lbs). Note: Apply anti-seize compound to Main Body (1) threads. After making proper electrical connections (see ballast manual), attach Projector Lid (5) to Main Body (1) using six Nuts (19) evenly tightened to 2 Nm (1.5 ft/lbs). Note: Upon completing light installation, it is highly recommended that Front Flange (22) be coated with antifouling paint.

## Serviceable Parts:

Lamp replacement is done by removing six Nuts (19) and Projector Lid (5), pulling old Lamp (12) out of Lamp Socket (11), carefully pushing new Lamp (12) into Lamp Socket (11) and then reversing said procedure. Note: Evenly tighten six Nuts (19) to 2 Nm (1.5 ft/lbs). Caution! Ensure that new lamp is clean and free of dust, dirt, grease, oil, water and finger prints.

Glass (6) replacement is done by removing eight fasteners (15), Glass Retaining Flange (2) with attached Main Body (1) and Glass Gaskets (7) while the boat is out of the water. Upon thoroughly cleaning all surfaces, reverse said procedure to assemble new Glass (6) and Glass Gaskets (7). Note: Tighten fasteners (15) in a criss-cross pattern to 9 Nm (7 ft/lbs) using a 5mm allen wrench.

MODEL E14_10A12-16A18A, 120VAC OR 240VAC, 250W		
BALLOON	PART	DESCRIPTION
1	37001	MAIN BODY
2	37003	GLASS RETAINING FLANGE
3	37004	REFLECTOR
4	37028	REFLECTOR BUSHING
5	37006	PROJECTOR LID
6	37007	GLASS
7	37008	GLASS GASKET
8	37009	MAIN BODY GASKET
9	37010	RETAINING FLANGE O-RING
10	37011	PROJECTOR LID O-RING
11	37030	LAMP SOCKET
12	37031	LAMP, 250 WATT
13	37015	PORCELAIN TERMINAL BLOCK
14	37016	CABLE STRAIN RELIEF
15	37017	M6 x 1.0 x 25LG SST SHCS
16	37036	M3 x 0.5 x 20LG SST SHCS
17	37035	M4 x 0.7 x 35LG SST SHCS
18	37019	M6 x 1.0 x 25LG SST SET SCREW
19	37020	M6 x 1.0 SST HEX LOCKNUT
20	37033	STAND-OFF
21	37034	LAMP SOCKET SPACER
22	N/A	CALL TECHNICAL SUPPORT FOR APPROPRIATE FRONT FLANGE

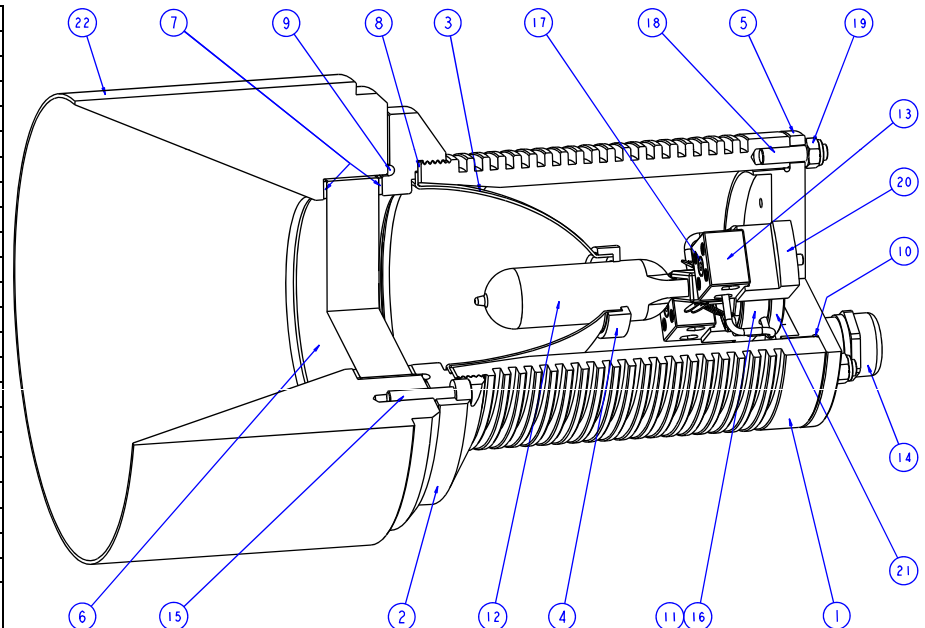

Underwater Lights USA, LLC  
1881 W State Road 84, Bay 102  
Fort Lauderdale, FL 33315 USA  
Phone: 1-954-760-4447  
Fax: 1-954-525-3261  
Internet: [www.seavision.com](http://www.seavision.com)  
Email: [sales@seavision.com](mailto:sales@seavision.com)

DOC:121706-4

Underwater Lights Europe Sarl  
Résidence L'Hippocampe: 19, Avenue Thiers  
06600 Antibes, France  
Phone: 33-(0)-4-97-21-02-96  
Fax: 33-(0)-4-97-21-10-96  
Internet: [www.seavision.com](http://www.seavision.com)  
Email: [sales@seavisioneurope.com](mailto:sales@seavisioneurope.com)

## Weld-in Front Flange Selection for **ALUMINUM** Hulled Vessels

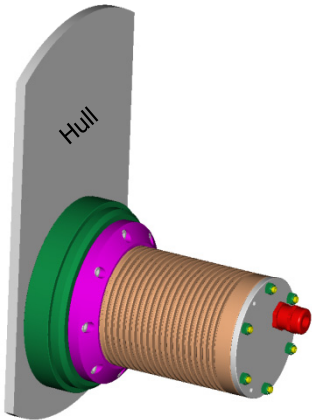

*Light with 0° to 10°  
ALUM Front Flange  
(37024)*

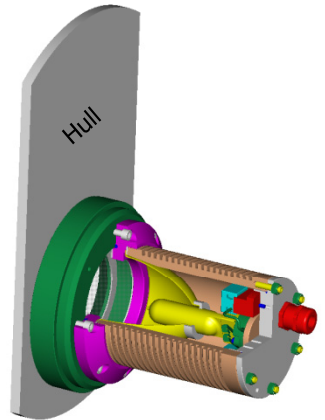

*Light with 10° to 30°  
ALUM Front Flange  
(37051)*

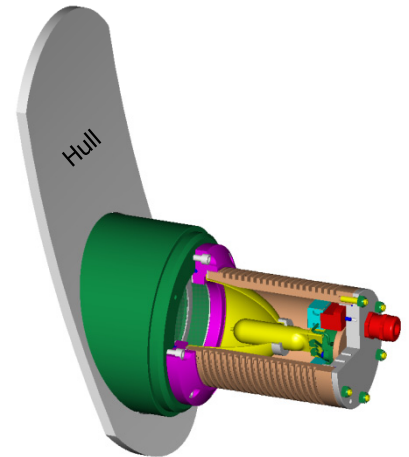
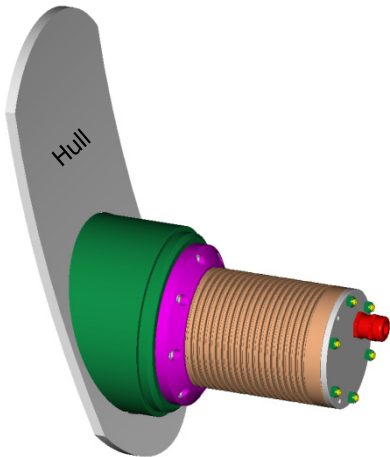

## Weld-in Front Flange Selection for **ALUMINUM** Hulled Vessels

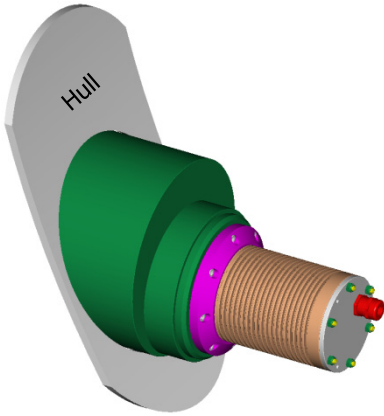

*Light with 24° to 38°  
ALUM Front Flange  
(37054)*

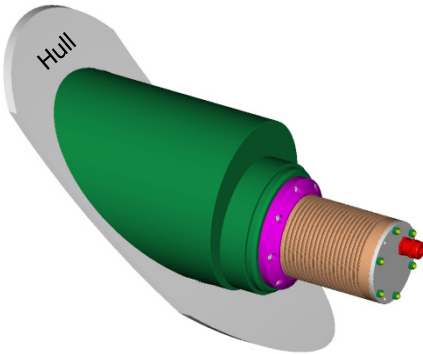
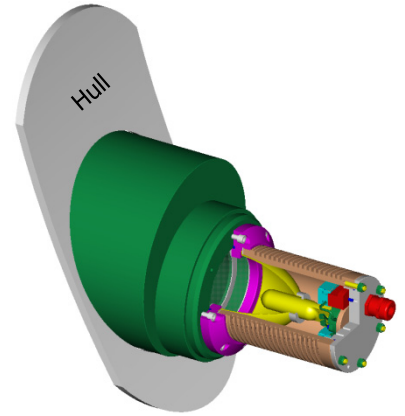

*Light with 38° to 50°  
ALUM Front Flange  
(37057)*

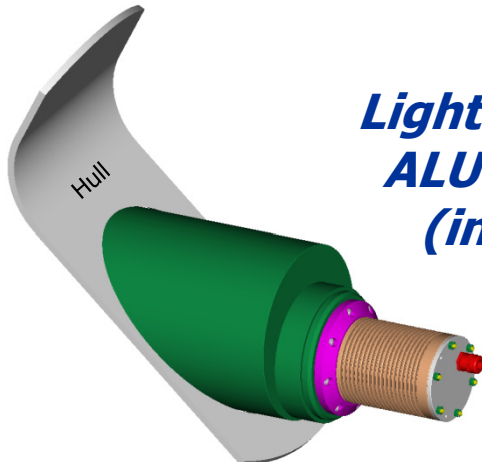
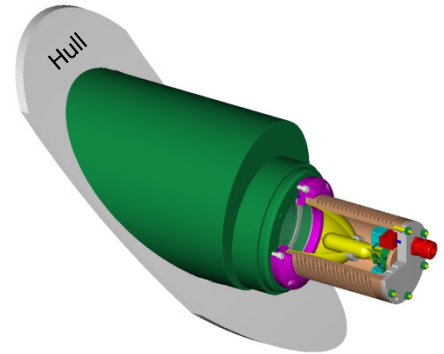

*Light with 38° to 50°  
ALUM Front Flange  
(in hull bottom)*

