



This light can be surface mounted or flush mounted using a weld-in insert in aluminum 5083 or stainless steel 316 L. It should be used for any area needing general or low level lighting, such as steps, walkways and deckheads. It can also be used as a flood light if the maximum 50 watt lamp is used. The bezel is machined stainless steel 316 L and available bolted to ensure a strong exterior for exposed areas or screwed for less exposed areas and a cleaner / smoother finish. It is available with a frosted or clear lens depending on how much light is required. This light uses the best quality materials and is designed for longevity and tested for water tightness to IP66. DV23 is available with an MR16, halogen lamp maximum 50 watts in 12 or 24 volt.



DV23 technical specifications

Application for:	Steps, walkways, deckheads and flood lights
Finish:	Polished stainless steel 316 L
Bezel:	Screwed or bolted
Glass lens:	Frosted or clear
Power supply:	12 volt d.c./a.c. - 4.3 amps 24 volt d.c. - 2.2 amps
Lamp:	Halogen, maximum wattage 50 watts 12/24 volt
Dimensions:	Bezel: 3.7" / 95mm Depth: 4.7" / 120mm Cut-out: 2.5" / 64mm
IP rating:	66



*All information is subject to change without prior notice, please confirm details prior to ordering.
For further technical installation information, please visit www.seavision.com*

DV23 Light

12VDC/50W
24VDC/50W



Introduction:

Congratulations on the purchase of your new deck light. Underwater Lights® USA, LLC takes pride in providing well designed, high quality and thoroughly tested lights that allow you to “enhance your boating experience”. These lights can be installed in your vessel for aesthetics, security and safety.

General Operating Information:

The commercial grade Halogen lamp used in this light will provide robust and reliable operation under normal operating conditions.

General Safety Information:

This light is intended for vessel interior or exterior (rain or indirect water spray) lighting applications.

Always disconnect and lock-out power before working on light.

Technical Specifications:

Lamp = 50 Watt - 12VDC - Halogen - 3000 Kelvin color temperature - Approximately 4,000 hours life

Lamp = 50 Watt - 24VDC - Halogen - 3000 Kelvin color temperature - Approximately 2,000 hours life

Glass = Frosted borosilicate glass - 3.2mm (0.125”) thick - 55.5mm (2.19”) diameter net aperture

Dimensions = 95mm (3.74”) diameter x 120mm (4.7”) long - 630 grams (1.4 lbs) - Fits through a 64mm (2.5”) diameter hole

Construction = Stainless Steel - Black anodized marine aluminum alloy

Power supply = 12VDC / AC - 4.3 Amps, 24VDC - 2.2 Amps - Minimum operating temperature -30°C (-22°F)

Troubleshooting:

Please contact our technical support staff in Florida at 1-954-760-4447, Monday to Friday from 8:00 am to 5:00 pm EST.

Warranty:

Underwater Lights® USA, LLC warrants this light to be free from defects in workmanship and materials for a period of one year from the date of original purchase (except lamps). Further, misuse, abuse, improper installation, neglect, improper shipping, damage caused by disasters such as fire, flood and lightning, unauthorized repair or modifications will void said warranty. Should your light prove defective during the warranty period, promptly contact Underwater Lights® USA, LLC for an RMA number and then return the light freight prepaid with the RMA number clearly marked on the outside of the shipping container.

Underwater Lights USA, LLC
1881 W State Road 84, Bay 102
Fort Lauderdale, FL 33315 USA
Phone: 1-954-760-4447
Fax: 1-954-525-3261
Internet: www.seavision.com
Email: sales@seavision.com

DOC:080105-6

Underwater Lights Europe Sarl
Résidence L'Hippocampe: 19, Avenue Thiers
06600 Antibes, France
Phone: 33-(0)-4-97-21-02-96
Fax: 33-(0)-4-97-21-10-96
Internet: www.seavision.com
Email: sales@seavisioneurope.com

DV23 Light

12VDC/50W
24VDC/50W



Installation:

After selecting a flat surface, cut a 64mm (2.5") diameter hole through said surface at the desired location. Caution! Check that no electrical wiring, fuel lines, oil lines, water lines etc., pass near or through the intended hole location.

Unscrew Front Flange (1) or remove Front Flange (19) with Screws (20) from the Main Body (3) and remove four supplied Phillips Flat Head Screws (12). Place Main Body (3) with Body Gasket (9) through above hole and secure using four Phillips Flat Head Screws (12). Note: Depending upon installation surface material, four small pilot holes may be required. Screw Front Flange (1) or replace Front Flange (19) with Screws (20) onto the Main Body (3) accordingly.

Connect the BLUE wire lead to a switched and fused power source and connect the BROWN wire lead to a good ground.

Serviceable Parts:

Lamp replacement is done by unscrewing the Front Flange (1) or removing the Front Flange (19) with Screws (20) from the Main Body (3), removing the Lamp Spring Clip (7) pulling the old Lamp (16) out of the Lamp Socket (15), pushing a new Lamp (16) into the Lamp Socket (15), replacing the Lamp Spring Clip (7) then screwing the Front Flange (1) or replacing the Front Flange (19) with Screws (20) onto the Main Body (3) accordingly. Caution! Ensure that the new lamp is clean and free of dust, dirt, grease, oil, water and finger prints. Additionally, the Glass (2) is not field serviceable on this light because it is permanently bonded to Front Flange (1) or (19).

BALLOON	PART	DESCRIPTION
1	23001	THREADED ON FRONT FLANGE, STAINLESS STEEL, MIRROR FINISH*
2	23010	GLASS, FROSTED*
3	23015	MAIN BODY, STAINLESS STEEL*
4	23018	SWIVEL CONE
5	23019	SWIVEL CUP
6	23020	SWIVEL SPRING
7	23021	LAMP SPRING CLIP
8	23022	LAMP COVER
9	23023	BODY GASKET
10	23025	INTERNAL RETAINING RING
11	23026	FRONT FLANGE O-RING
12	23027	No. 4 x 5/8" LG STAINLESS STEEL PHILIPS FLAT HEAD SCREW
13	23030	CABLE STRAIN RELIEF
14	23031	CABLE STRAIN RELIEF LOCK NUT
15	23032	LAMP SOCKET
16	23033 23036	LAMP, 50 WATT, 12VDC* LAMP, 50 WATT, 24VDC*
17	23055	M3 x 0.5 x 6 LG STAINLESS STEEL SOCKET HEAD CAP SCREW
18	23056	REFLECTOR, 40° BEAM ANGLE*
19	23045	SCREWED ON FRONT FLANGE, STAINLESS STEEL, MIRROR FINISH*
20	23054	M5 x 0.8 x 8 LG STAINLESS STEEL SOCKET FLAT HEAD SCREW

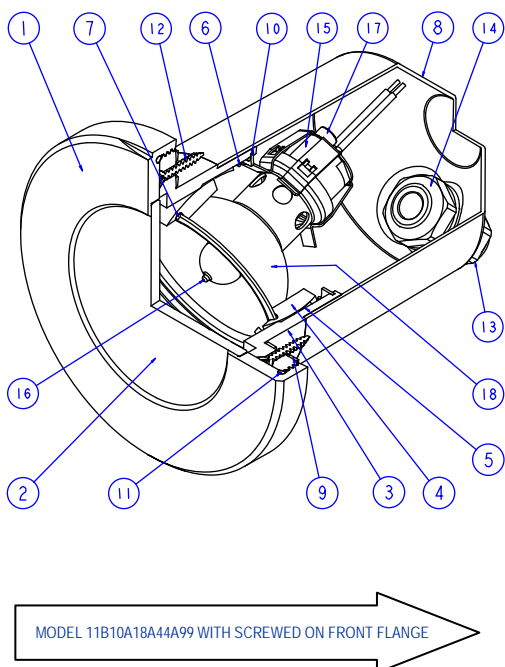

MODEL 10B10A18A44A99 WITH THREADED FRONT FLANGE

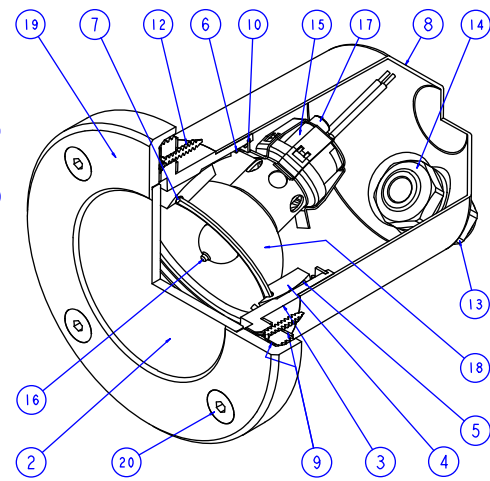

MODEL 11B10A18A44A99 WITH SCREWED ON FRONT FLANGE

Underwater Lights USA, LLC
1881 W State Road 84, Bay 102
Fort Lauderdale, FL 33315 USA
Phone: 1-954-760-4447
Fax: 1-954-525-3261
Internet: www.seavision.com
Email: sales@seavision.com

Underwater Lights Europe Sarl
Résidence L'Hippocampe: 19, Avenue Thiers
06600 Antibes, France
Phone: 33-(0)-4-97-21-02-96
Fax: 33-(0)-4-97-21-10-96
Internet: www.seavision.com
Email: sales@seavisioneurope.com